

LANDSCAPE/PLANT MATERIAL			REQUIRED PLANT MATERIAL SCHEDULE							
REQU.	EXISTING	PROV.	SYMBOL	QUAN.	COMMON NAME	SCIENTIFIC NAME	SIZE			REMARKS
5	2	3					HT.	SPRD.	CAL.	
RAINBOW AVENUE FRONTAGE BUFFER/SIDE CANOPY TREES:					TREES (CANOPY)					
			MG	3	SOUTHERN RED CEDAR	JUNIPERUS SILICICOLA	12'	24" MIN.	B & B	FULL, MULTI-TRUNK

ALL WORK SHALL BE DONE IN ACCORDANCE WITH THE LATEST EDITION OF E.C.U.A.'S ENGINEERING MANUAL.
 EQUA PROJECT INSPECTOR: _____

Hatch Mott MacDonald
 Engineers Surveyors
 Architects
 5111 North 12th Avenue (2804)
 P. O. Box 2516 (2813-2516)
 Tallahassee, FL 32310
 Telephone: (904) 484-6011 • Fax: (904) 484-4199

CENTRAL WATER RECLAMATION FACILITY
 REGIONAL LIFT STATION "A"
 ESCAMBIA COUNTY, FLORIDA
 EMERALD COAST UTILITIES AUTHORITY
 E.C.U.A. PROJECT NO. CST41B

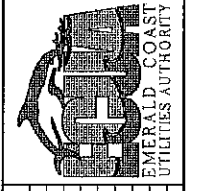

DATE	REVISION	DESCRIPTION
MARCH 2008	0	ISSUED FOR BID
03-24-08	1	ADDENDUM #1
04-09-08	2	GENERATOR SEAR MODIFICATION
03-06-09	3	DRAINAGE, GRADING & STABILIZATION MOD. 3
08-28-09		

DATE	DESIGNED BY	CONSTRUCTION DOCUMENTS
MARCH 2008	S. D. W.	STEVEN D. WHITE, P.E. FLORIDA LICENSE NO. 59809
	J. E. A.	
	S. D. W.	
	D. KECK	
	H. J. M.	
	PROJECT NUMBER: 227509DD04	

SHEET TITLE:
GRADING, DRAINAGE, AND LANDSCAPE PLAN
 SHEET NUMBER:
C1.4

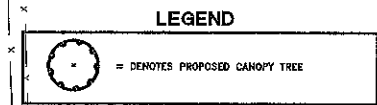
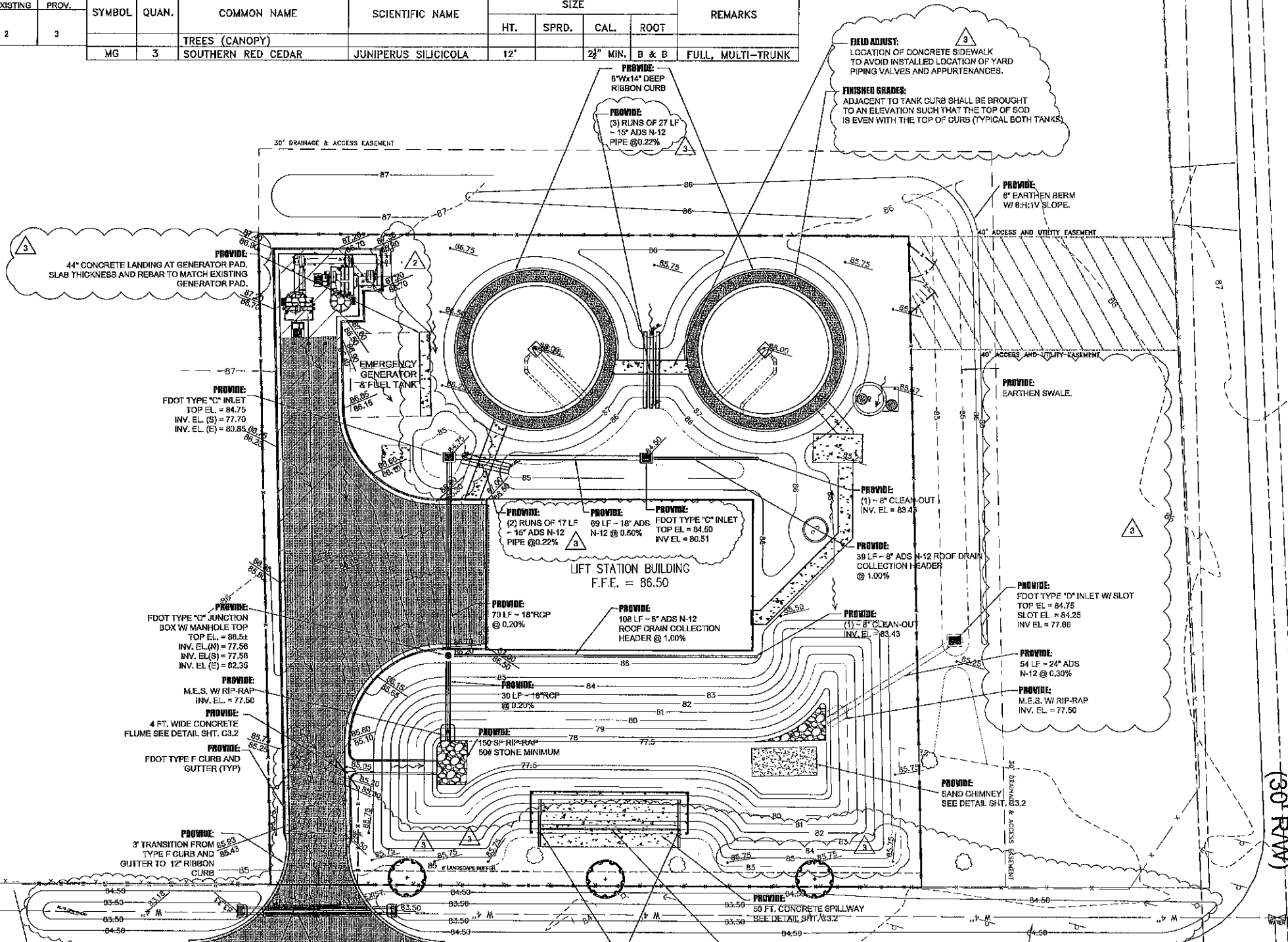

*NOTE:
 1. ROOF DRAINAGE/RUNOFF SHALL BE DIRECTED TO STORMWATER MANAGEMENT SYSTEM.

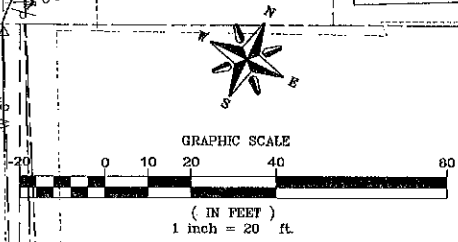
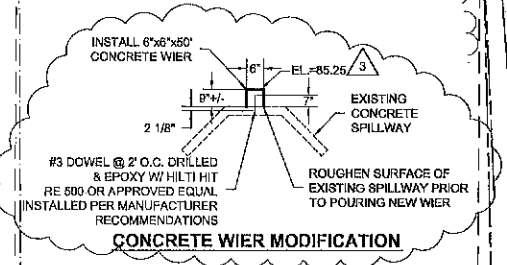
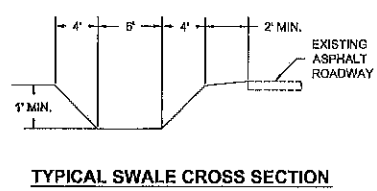
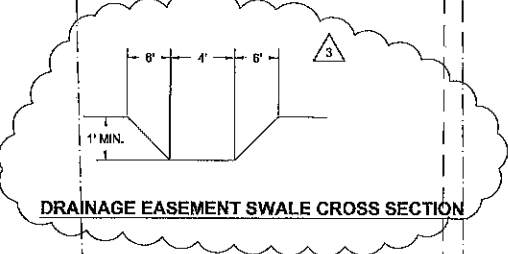

Pipeline Rd. RLS

This drawing is the property of Hatch Mott MacDonald Florida, LLC, and may not be reproduced without written permission.

LANDSCAPE/PLANT MATERIAL	REQUIRED PLANT MATERIAL SCHEDULE											
	RECD.	EXISTING	PROV.	SYMBOL	QUAN.	COMMON NAME	SCIENTIFIC NAME	SIZE			REMARKS	
RAINBOW AVENUE FRONTAGE BUFFER/SOD CANOPY TREES:	5	2	3					HT.	SPRD.	CAL.		ROOT
				MG	3	TREES (CANOPY)						
						SOUTHERN RED CEDAR	JUNIPERUS SILICICOLA	12'		2 1/2" MIN.	B & B	FULL, MULTI-TRUNK

ALL WORK SHALL BE DONE IN ACCORDANCE WITH THE LATEST EDITION OF E.C.U.A.'S ENGINEERING MANUAL.
 ECUA PROJECT INSPECTOR: _____

Hatch Mott MacDonald
 Engineers
 Architects
 Surveyors
 AA-C-0000155
 AA-C-0000156
 AA-C-0000157
 AA-C-0000158
 AA-C-0000159
 AA-C-0000160
 AA-C-0000161
 AA-C-0000162
 AA-C-0000163
 AA-C-0000164
 AA-C-0000165
 AA-C-0000166
 AA-C-0000167
 AA-C-0000168
 AA-C-0000169
 AA-C-0000170
 AA-C-0000171
 AA-C-0000172
 AA-C-0000173
 AA-C-0000174
 AA-C-0000175
 AA-C-0000176
 AA-C-0000177
 AA-C-0000178
 AA-C-0000179
 AA-C-0000180
 AA-C-0000181
 AA-C-0000182
 AA-C-0000183
 AA-C-0000184
 AA-C-0000185
 AA-C-0000186
 AA-C-0000187
 AA-C-0000188
 AA-C-0000189
 AA-C-0000190
 AA-C-0000191
 AA-C-0000192
 AA-C-0000193
 AA-C-0000194
 AA-C-0000195
 AA-C-0000196
 AA-C-0000197
 AA-C-0000198
 AA-C-0000199
 AA-C-0000200

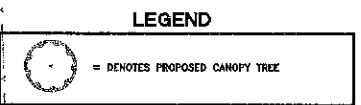

***NOTE:**

1. ROOF DRAINAGE/RUNOFF SHALL BE DIRECTED TO STORMWATER MANAGEMENT SYSTEM.

CENTRAL WATER RECLAMATION FACILITY
 REGIONAL LIFT STATION "A"
 ESCAMBIA COUNTY, FLORIDA
 EMERALD COAST UTILITIES AUTHORITY
 E.C.U.A. PROJECT NO. CS141B

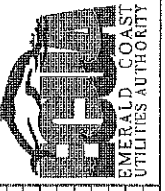

DATE	DESIGNED BY	DRAWN BY	PROJECT	CIVIL ENGINEER	MANAGER	S.I.M.M. PROJECT NUMBER	DATE	REV.	REVISION DESCRIPTION
MARCH 2008	S. D. W.	J. E. A.	GENERATOR SLAB MODIFICATION	S. D. W.	D. KECK	227803DD04	03-24-08	0	ISSUED FOR BID
							04-09-08	1	ADDENDUM #1
							03-08-09	2	GENERATOR SLAB MODIFICATION
							03-25-09	3	DRAINAGE GRADING & STABILIZATION MOD.'S

CONSTRUCTION DOCUMENTS	DATE	REV.	SEAL
STEVEN D. WHITE, P.E. FLORIDA LICENSE NO. 58609			

SHEET TITLE:
GRADING, DRAINAGE, AND LANDSCAPE PLAN

SHEET NUMBER:
SOD

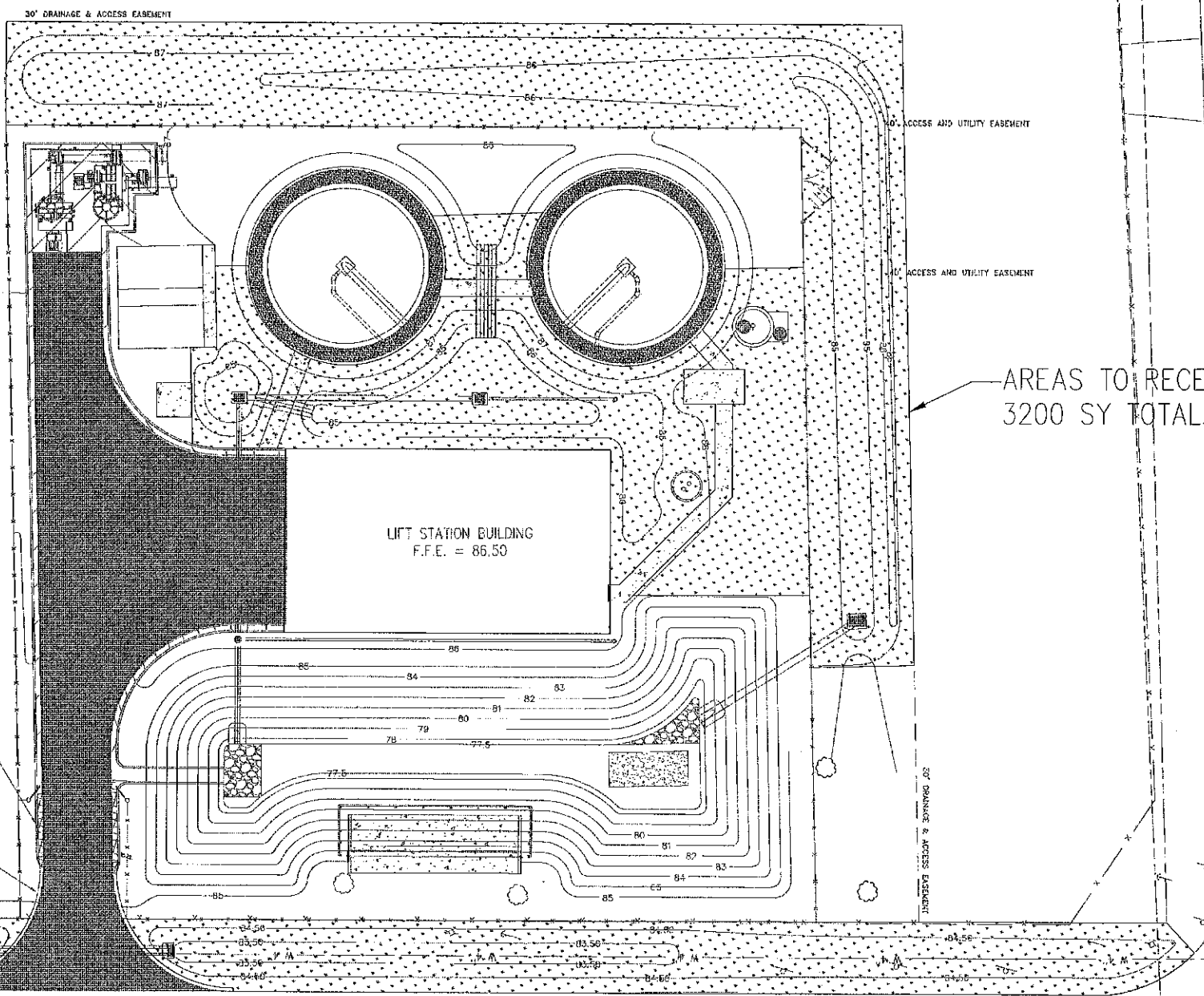

AREAS TO RECEIVE SOD
 3200 SY TOTAL.

PROVIDE:
 FDOT TYPE F CURB AND GUTTER (TYP)

PROVIDE:
 3' TRANSITION FROM TYPE F CURB AND GUTTER TO 12" RIBBON CURB

PIPELINE ROAD
 (30' R/W)

RAINBOW AVE.
 (65' R/W)

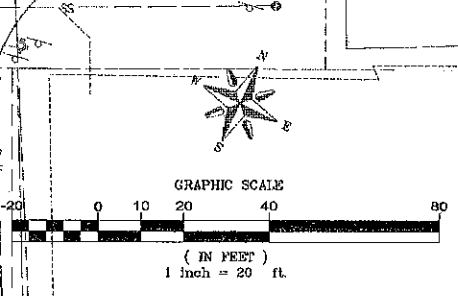

Pipeline Rd. RLS

This drawing is the property of Hatch Mott MacDonald Florida, LLC, and may not be reproduced without written permission.